

Model		CLB740H
Initial dimensions (mm) ^{*1}	Diameter	7.85
	Height ^{*2}	4.0
Weight (g) ^{*1}		0.5
Charge (CCCV)	Max. voltage (V)	4.2
	Standard current (mA)	9.5
	Temperature (deg. C)	0 to +45
Discharge (CC)	End voltage (V)	3.0
	Max. current (mA)	19
	Temperature (deg. C)	-20 to +60
Nominal voltage (V)		3.8
Nominal capacity (mAh) ^{*3}		19

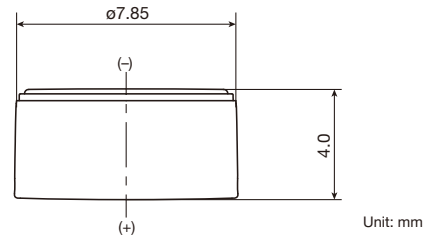

- UL 1642 Recognized models (Technician Replaceable): Certification Number: MH12568
- IEC 62133-2 Recognized models
- UN 38.3 (Dangerous goods transportation regulations) Recognized models

Characteristics

● Charge characteristics

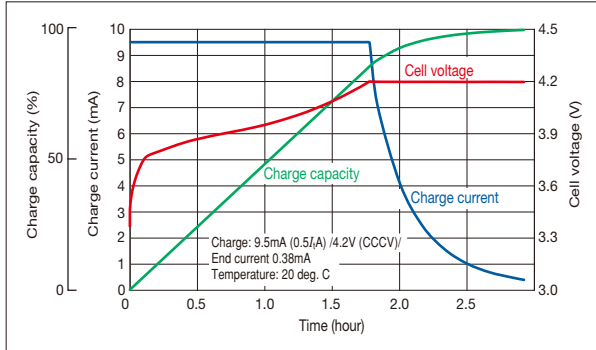

● Discharge temperature characteristics

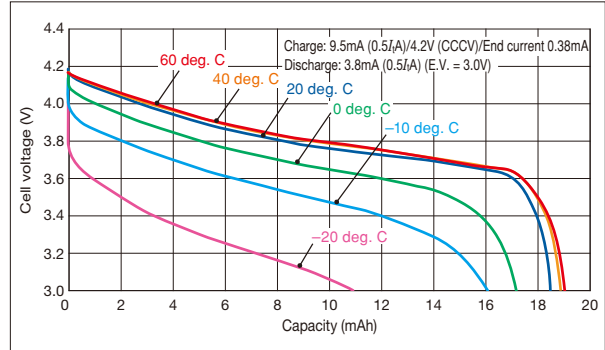

● Discharge load characteristics

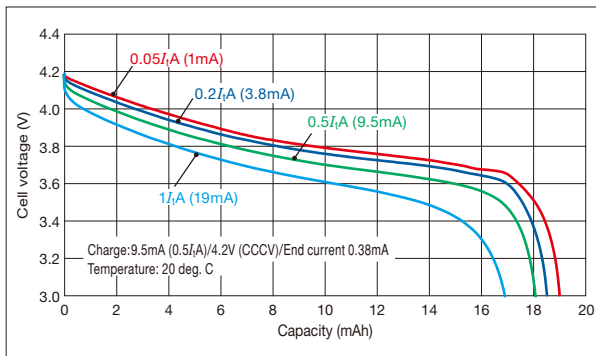

● Cycle life characteristics

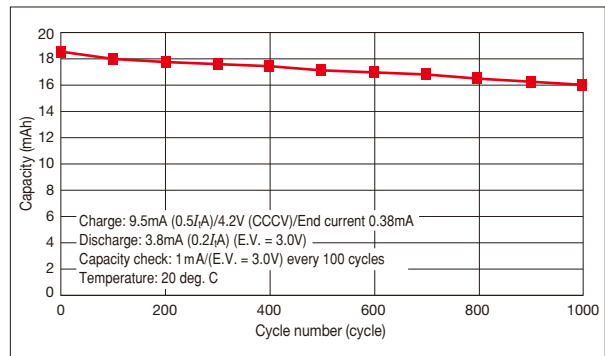

*1 Dimensions and weight are for the battery itself, but may vary depending on terminal specifications and other factors.

*2 100% charged

*3 Nominal capacity is according to the following conditions: Charge: 0.5I_t/4.2V (CCCV)/End current 0.02I_t, Discharge: 1mA/E.V. = 3.0V, Temperature 20 deg. C